

Installing Duma-Board

Duma-Board is very easy to cut and install. Depending on the circumstances, there are three possible installation methods:

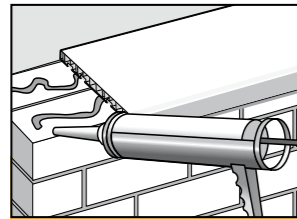

A. gluing

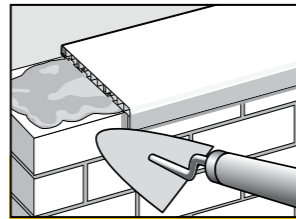

B. laying in mortar

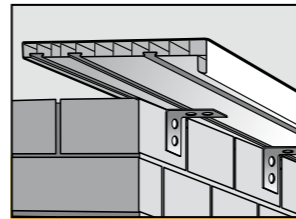

C. screwing

Installing Duma-Frame

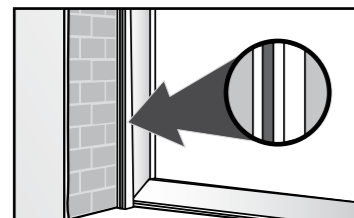

1. Installation of the start profile if necessary

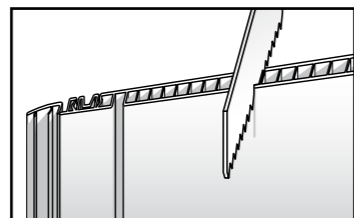

2. Cut panel to length

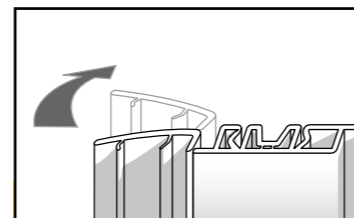

3. Remove side profile

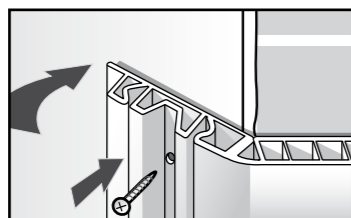

4. Bend the panel and fix at the desired angle with glue and/or screws

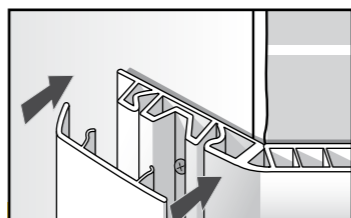

5. Click side profiles into position

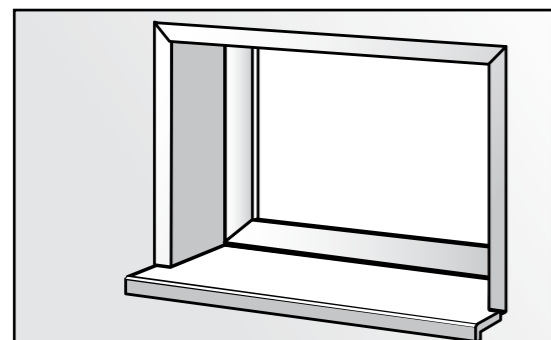

6a. Finished effect with a 90° and a wall thickness of 25 cm or less

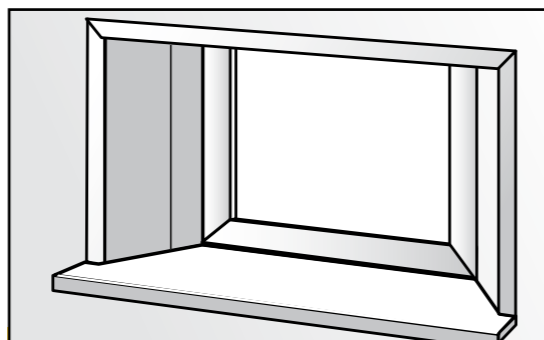

6b. Finished effect with an obtuse angle and a wall thickness greater than 25 cm

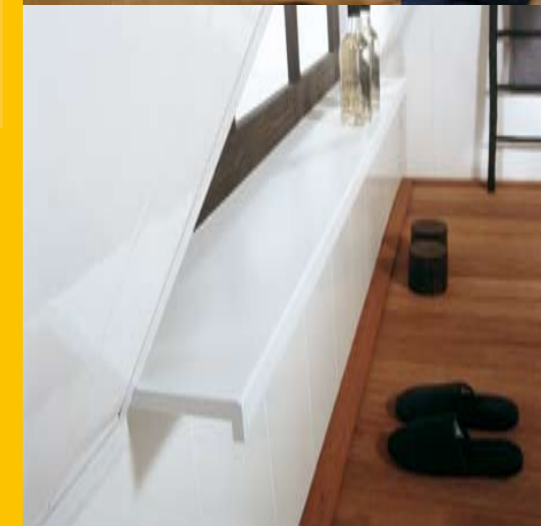

DUMA-BOARD

The durable Duma-Board internal window sill is made in hard recycled PVC with internal reinforcing ribs. The high quality PVC surface foil makes the window sill extremely hard-wearing and completely damp-proof.

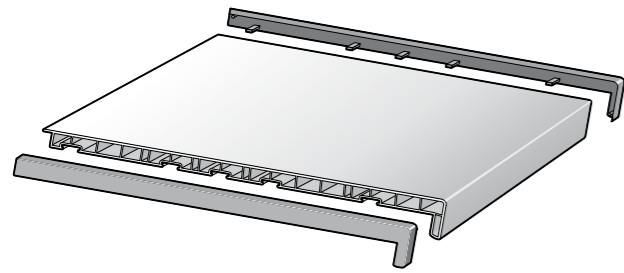

Benefits

- **WATER RESISTANT**

Duma-Board neither swells nor delaminates under the influence of water, and is thus the ideal finish in rooms with a moist atmosphere.

- **HARD-WEARING**

The durable, high quality surface foil offers years of resistance to domestic wear and tear.

- **DURABLE**

Distortion or warping is prevented by the exceptionally strong reinforcing ribs.

- **COLOURFAST AND RETAINS SHAPE**

Duma-Board is colourfast. Direct sunlight will not warp the window sill.

- **MAINTENANCE-FRIENDLY**

Duma-Board is easy to maintain using ordinary household cleaners. Avoid harsh abrasives. Painting or varnishing is unnecessary.

- **EASY TO INSTALL**

The window sill can easily be cut to the right size using an ordinary saw. Installation is simple too: there are three methods, gluing, screwing at the bracing points or laying directly on wet mortar. The end pieces are glued.

Window sill

The various lengths, from 150 mm to 400 mm, are available in five colours: white, marble, beech, golden oak and mahogany

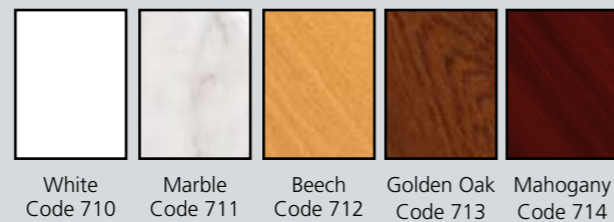
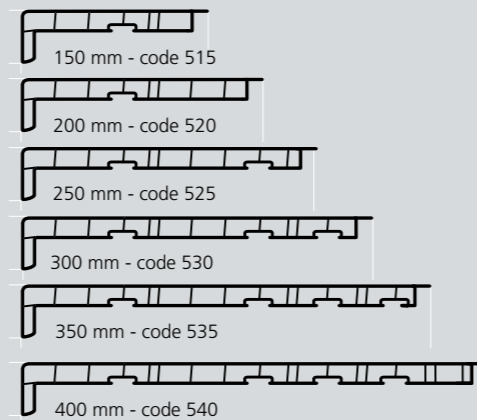

End pieces

End pieces are available in lengths of 300 mm and 400 mm in four colours*: white (marble), beech, golden oak and mahogany.

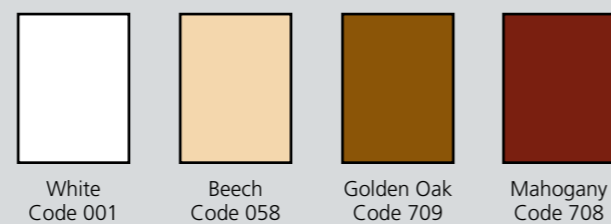
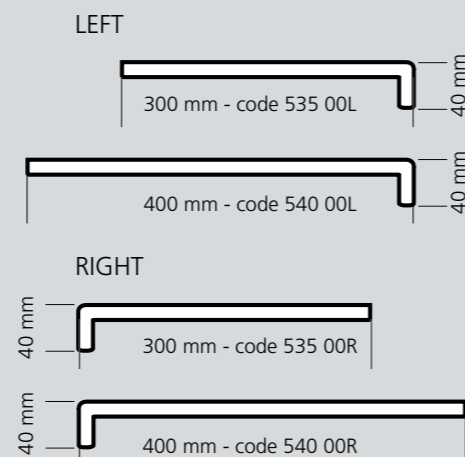

*400mm only available in white.



Benefits

- **ONE PIECE**

Duma-Frame consists of one single piece, so that no separate profiles are necessary for the reveal around the window frame.

- **UNIVERSAL**

The Duma-Frame profile can be used for the installation of both right-angled and oblique corners of more than 90°.

- **MATT GLOSS FINISH**

Duma-Frame has a matt gloss finish so that fingerprints are less prominent. This gloss finish also prevents the formation of extrusion lines along the length of the profile.

- **WATER-RESISTANT**

The use of PVC as the basic material means that the profiles are water-resistant and the formation of condensation is countered.

- **EASY TO INSTALL**

Installation can be done by both DIYer and professional.

- **COLOURFAST**

Direct sunlight has no impact on the colourfastness of the profile.

DUMA-FRAME

Duma-Frame provides an attractively finished profile for the window frame. No plaster or gypsum board is necessary, and the window frame can be finished in a simple, elegant manner.

Duma-Frame consists of a single piece, so separate support profiles are not necessary. The start profile can connect the window frame profile perfectly with the window, but it is not required. If the wall is more than 25 cm thick, the Duma-Frame profile can be extended with a separate matching V25 panel.

